

# Tetra<sup>®</sup> Contour

## LED Lighting System

(GEXNLG15, GERDXNLG15, GEPOXNLG15, GEYAXNLG15, GELGXNLG15, GEGLXNLG15, GEBLXNLG15)

### Step 1: Preparation

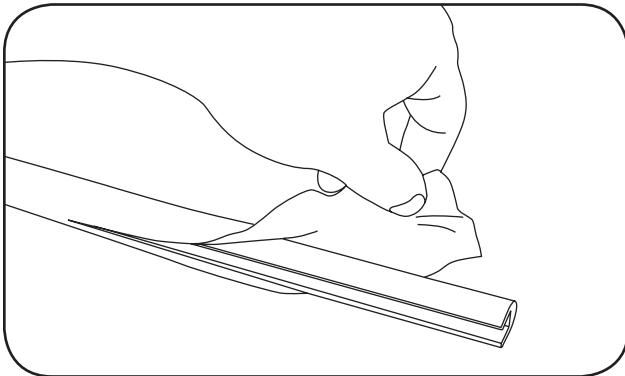

- 1 Remove the protective film from the light guide.

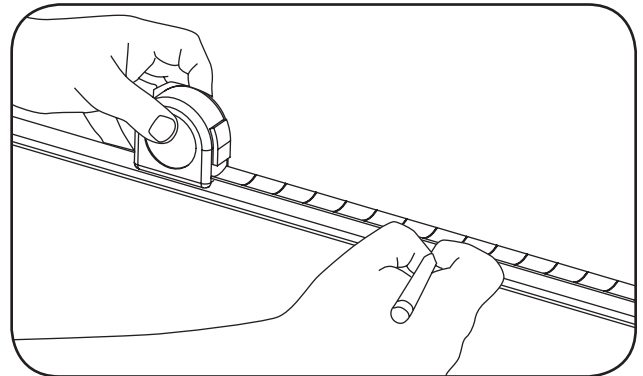

- 2 Mark the light guide at the required length, adding 0.5 in. (13mm) for every 16 in. (406mm) to account for shrinkage during the forming process.

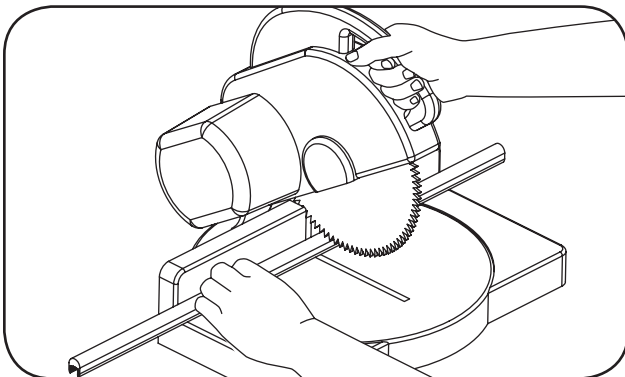

- 3 Cut the light guide to the required length using a hacksaw, chop saw (cross cut or veneer blade only), band saw, or other appropriate plastic cutting tool. Take the proper safety precautions when cutting the light guide.

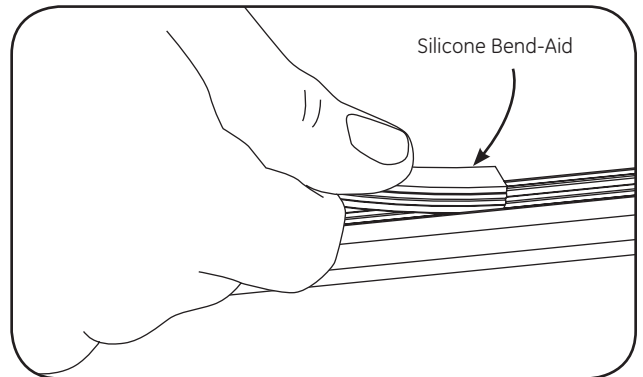

- 4 Fill the entire light guide channel with the Silicone Bend-Aid(s) (GEXNBA) and press into place. Bend-Aid must be installed prior to heating and forming.

**NOTE:** The Silicone Bend-Aid (GEXNBA) is reusable.



# Installation Guide

## Step 2: Heating and Forming

For large bends, use either an industrial oven or heating blanket.  
For small bends, use a heat gun.

Bend Type	Minimum Bend Radius
Planar	0.5 in. (13mm)
Inside Corner	1.0 in. (25mm)
Outside Corner	1.5 in. (38mm)

**⚠ CAUTION**

**RISK OF DAMAGE:** DO NOT use an open flame to heat the light guide. DO NOT heat and form the light guide with light engine installed.

**⚠ WARNING**

**RISK OF INJURY:** Avoid direct contact between hot materials and exposed skin or combustibles. Use heat resistant gloves while heating and/or handling any hot materials.

### Option A: Large Bends

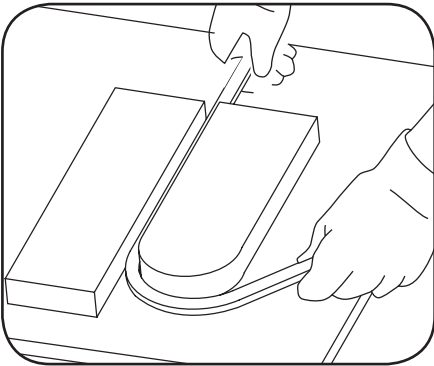

Preheat the heating equipment to 300°F (149°C). Heat light guides approximately 6-15 minutes until soft and pliable. Bend the light guide over a printed pattern, routed template, or use free-forming. A clean flat insulated surface (wood or laminated countertop) will help to prevent twisting or bowing. See the chart above for minimum bend radius guidelines.

### Option B: Small Bends

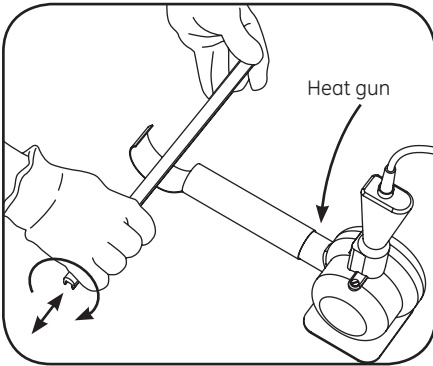

**Part 1:** Move the section back and forth while rotating about the diameter until it is soft and pliable. Gently bend to the desired angle.

**NOTE:** It is recommended to use a heat-deflecting shield to distribute the heat evenly.

**NOTE:** Avoid localized overheating that may result in distortion or damage (i.e. bubbling) of the light guide.

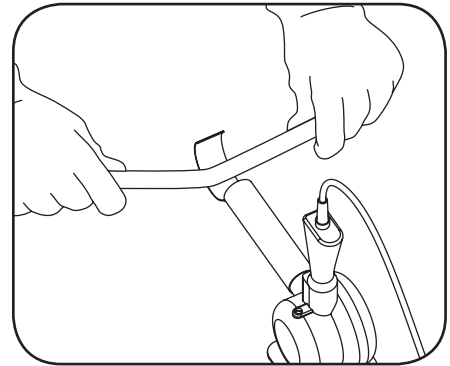

**Part 2:** The workable forming time is about 2-3 minutes. The light guide must remain in the desired position until completely cooled. See the chart above for minimum bend radius guidelines.

Allow the light guide to cool by natural convection or lightly forced cool air (i.e. fan). Remove the Bend-Aids for reuse only after the light guide has completely cooled. In order to remove any minor surface flaws, perform a light sanding using 400 grit sandpaper. Flared or deformed ends can be trimmed. The light guide is now ready for light engine installation.

**⚠ CAUTION**

**RISK OF DAMAGE:** DO NOT subject heated light guide to freezing or quenching in water.



6180 Halle Drive • Valley View, Ohio 44125-4635 • USA  
P: 216.606.6555 • F: 216.606.6599 • www.led.com • info@led.com

For customer service & technical support, contact:  
**1-888-MY-GE-LED** (1.888.694.3533)

Lumination, LLC is a subsidiary of the General Electric Company. Tetra is a trademark of Lumination, LLC. The GE brand, logo, and ecomagination are trademarks of the General Electric Company. © 2008 Lumination, LLC. Information provided is subject to change without notice. All values are design or typical values when measured under laboratory conditions.